

# SOUTH BANK OUTDOOR VENUE HIRE

EMAIL | [EVENTS@COINSTREET.ORG](mailto:EVENTS@COINSTREET.ORG)

TELEPHONE | 020 7021 1650

Coin Street   
community builders



# SOUTH BANK OUTDOOR VENUE HIRE CONTENTS

Coin Street Community Builders (CSCB) is a social enterprise and our aim is to make our neighbourhood a great place to live, work in, and visit.

Since 1984 CSCB has transformed a largely derelict 13 acre site into a thriving mixed-use neighbourhood.

IF YOU'VE  
GOT THE VISION,  
WE'VE GOT  
THE VIEWS

	PAGE
Coin Street site plan (looking west)	3
Coin Street site plan (looking east)	4
Observation Point	8 – 9
Riverside Grass	11 – 12
Riverside Central and Riverside West	14 – 15
Bernie Spain Gardens	17 – 18
Queen's Stone	19 – 20
Oxo Jetty, Queen's Stone Jetty and Riverside Slice	21 – 22
Doon Street Car Park	24 – 25
Green Space	26 – 27
Courtyard & Platform	29 – 30
OXO Tower	31 – 32
Bargehouse	33
gallery@oxo	34
G11	35
Filming on our sites	36
Rates, additional services, fees and promotional opportunities	37
Coin Street Conference Centre	38
Why choose Coin Street?	39



# COIN STREET SITES

EMAIL | [EVENTS@COINSTREET.ORG](mailto:EVENTS@COINSTREET.ORG)

TELEPHONE | 020 7021 1650

3



WATERLOO STATION

PLATFORM & COURTYARD

COIN STREET CONFERENCE CENTRE

GREEN SPACE

OXO TOWER

DOON STREET CAR PARK

BARGEHOUSE

BERNIE SPAIN GARDENS

RIVERSIDE WEST

RIVERSIDE GRASS

RIVERSIDE SLICE

RIVERSIDE CENTRAL

OBSERVATION POINT

G11

QUEEN'S STONE

QUEEN'S STONE JETTY

GALLERY@OXO

OXO JETTY



# COIN STREET SITES

EMAIL | [EVENTS@COINSTREET.ORG](mailto:EVENTS@COINSTREET.ORG)  
TELEPHONE | 020 7021 1650

4



BLACKFRIARS STATION

G11

OXO TOWER

OXO JETTY

QUEEN'S STONE JETTY

OBSERVATION POINT

RIVERSIDE GRASS

RIVERSIDE WEST

RIVERSIDE SLICE

QUEEN'S STONE

RIVERSIDE CENTRAL

GREEN SPACE

PLATFORM & COURTYARD

BARGEHOUSE

GALLERY@OXO

BERNIE SPAIN GARDENS

COIN STREET CONFERENCE CENTRE

DOON STREET CAR PARK



# GLOBAL AUDIENCES LOCAL REACH

Our outdoor event spaces are perfect for showcasing regional and international services. The diverse audience includes tourists, local employees, residents, Londoners and South Bank visitors.





# WHO VISITS THE SOUTH BANK?

Home to some of the world's most successful businesses, the nation's leading arts and media organisations and a growing residential population.



## SOUTH BANK FOOTFALL & DEMOGRAPHICS

An average of  
**30,000 VISITORS**  
per day walk along the Riverside Walkway

South Bank is home to  
**55,700 JOBS**  
and  
**11,000 RESIDENTS**

Attracts an estimated  
**25 MILLION**  
visitors to the South Bank every year

Notable new South Bank developments include

- DOON STREET
- ONE BLACKFRIARS
- 240 BLACKFRIARS ROAD
- SEA CONTAINERS HOUSE  
(home to Ogilvy & Mather, Mondrian London hotel and Puma)

South Bank visitor expenditure equates to approximately  
**£240 MILLION**  
per year

Waterloo Station is the UK's busiest station with  
**100 MILLION JOURNEYS**  
each year and is set to grow by 20% in the next 5–10 years

Current developments proposed in the area will create  
**16,500 NEW JOBS**  
and create new homes for  
**4,800 RESIDENTS**

**40%** of Waterloo Station users exit in the surrounding public realm

SOURCE: 'Supporting Growth in the South Bank: Summary Report' Volterra Partners, November 2012





ICONIC  
VIEWS

# OBSERVATION POINT

With the backdrop of St Paul's Cathedral and the City and overhanging the Thames, the Observation Point offers highly sought after stunning iconic vistas from the South Bank.

The 497m<sup>2</sup> cobbled riverside site has provided the perfect location for a multitude of experiential and launch events, feature films, worldwide tourism promotions, including an Olympic broadcast studio and plays regular host to ITV's This Morning and Good Morning Britain live broadcasts.

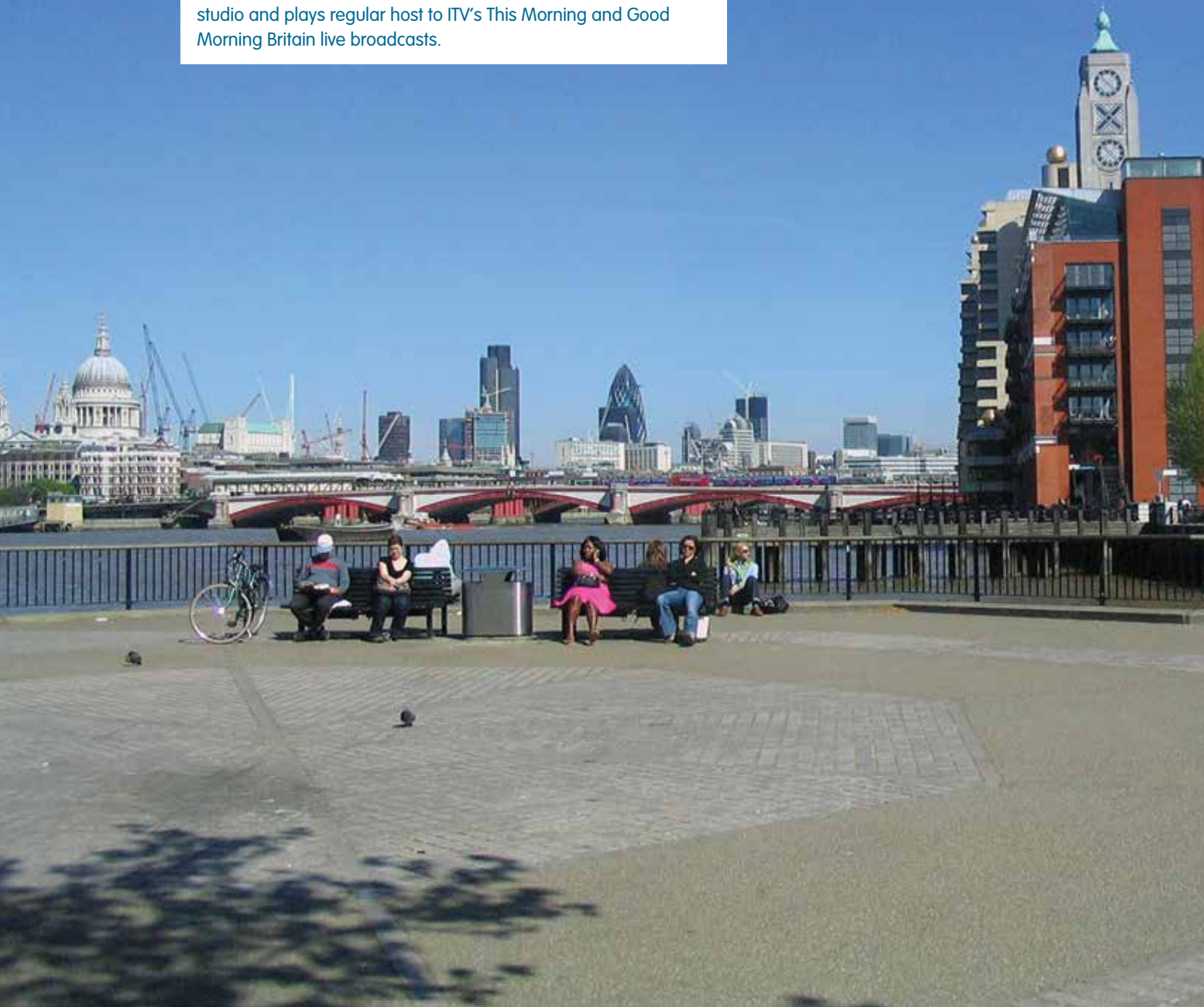

EMAIL | [EVENTS@COINSTREET.ORG](mailto:EVENTS@COINSTREET.ORG)

TELEPHONE | 020 7021 1650

8

“Coin Street is a good event partner with great spaces. Where else in London can you find a variety of flexible spaces with a huge footfall of inquisitive people?”

**Your Audience Ltd**



DKNY



DUREX EMBRACE



ANDRE RIEU PERFORMANCE



**OBSERVATION POINT**  
AREA = 497m<sup>2</sup>  
PERIMETER = 96m

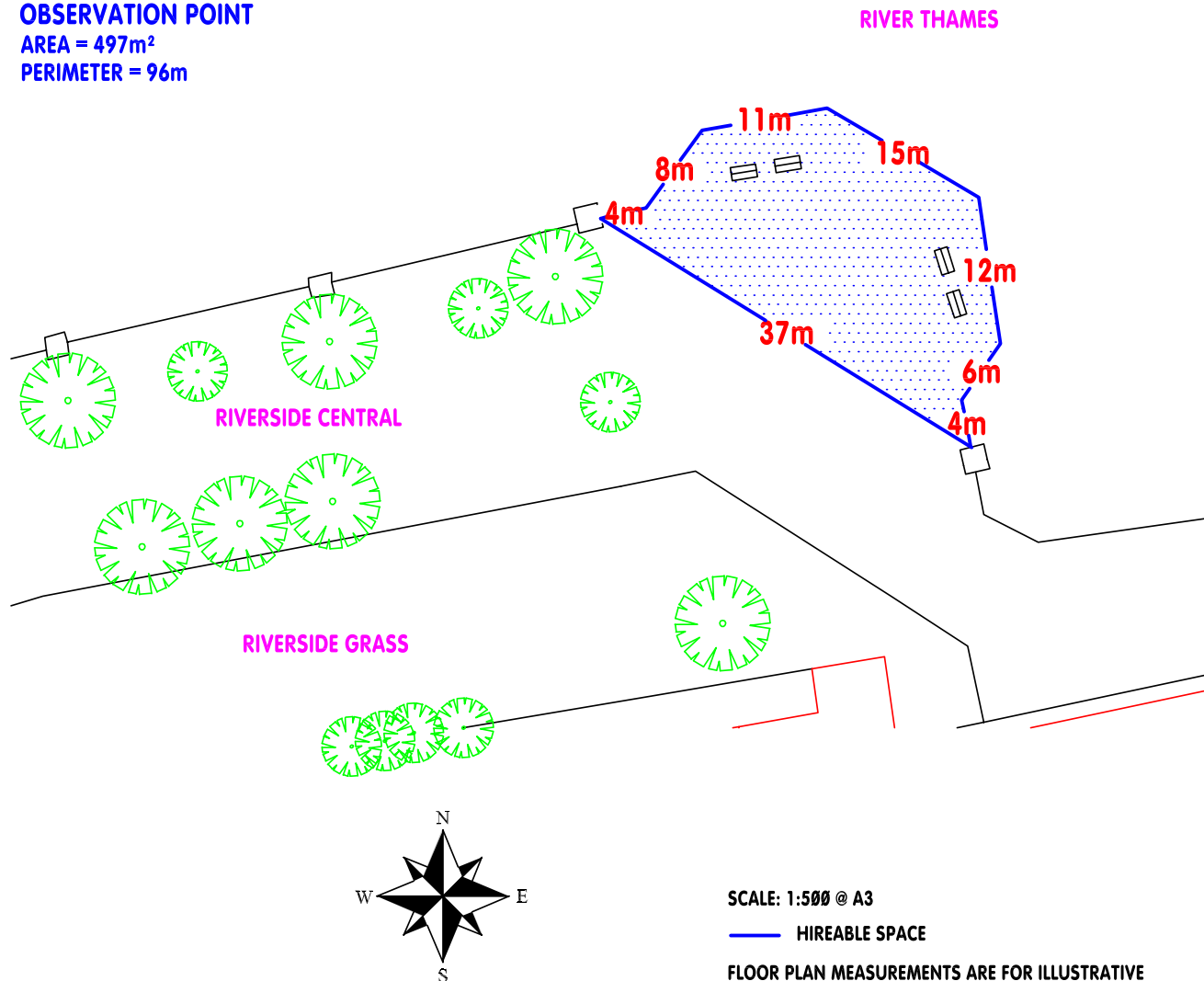

<b>SIZE</b>	497m <sup>2</sup>
<b>SURFACE</b>	Cobble and clear mac resin
<b>POWER</b>	2x16 amp single phase + (subject to availability) 1x63 amp 3 phase supply or 2x31 + 2x16 amp single phase supplies
<b>WATER</b>	Tap access near to site
<b>ACCESS</b>	Vehicle access to site (size and weight restrictions apply)
<b>CAD PLAN AVAILABLE ON APPLICATION</b>	

“The beauty of the Observation Point is the aspect and enormous footfall which guarantees any brand engagement having the best chance of tangible impact and serious ROI. The interactive tree projection we did for John Lewis perfectly illustrated that with thousands of people stopping and photographing it.”

**CURB**



AL JAZEERA OLYMPIC STUDIO



# WORLD CLASS LOCATION

EMAIL | [EVENTS@COINSTREET.ORG](mailto:EVENTS@COINSTREET.ORG)  
TELEPHONE | 020 7021 1650

10





# RIVERSIDE GRASS

Adjacent to the South Bank Riverside Walkway and offering picturesque views of the Thames, the Riverside Grass provides 2,385m<sup>2</sup> of outdoor green canvas. Greek beaches, a swimming pool and festivals of all types have featured on this adaptable oasis on the South Bank. In addition the trees along the adjoining walkway house twinkling blue and white lighting installations adding sparkle to evening and night-time events.

EMAIL | [EVENTS@COINSTREET.ORG](mailto:EVENTS@COINSTREET.ORG)  
TELEPHONE | 020 7021 1650

11

“I highly value our partnership with Coin Street for experiential activities on the South Bank.”

**JC Decaux Live**



BRITISH GAS POOLS 4 SCHOOLS



ANT & DEC'S SATURDAY NIGHT TAKEAWAY



MALAYSIA KITCHEN



# RIVERSIDE GRASS

## TECHNICAL SPECIFICATIONS

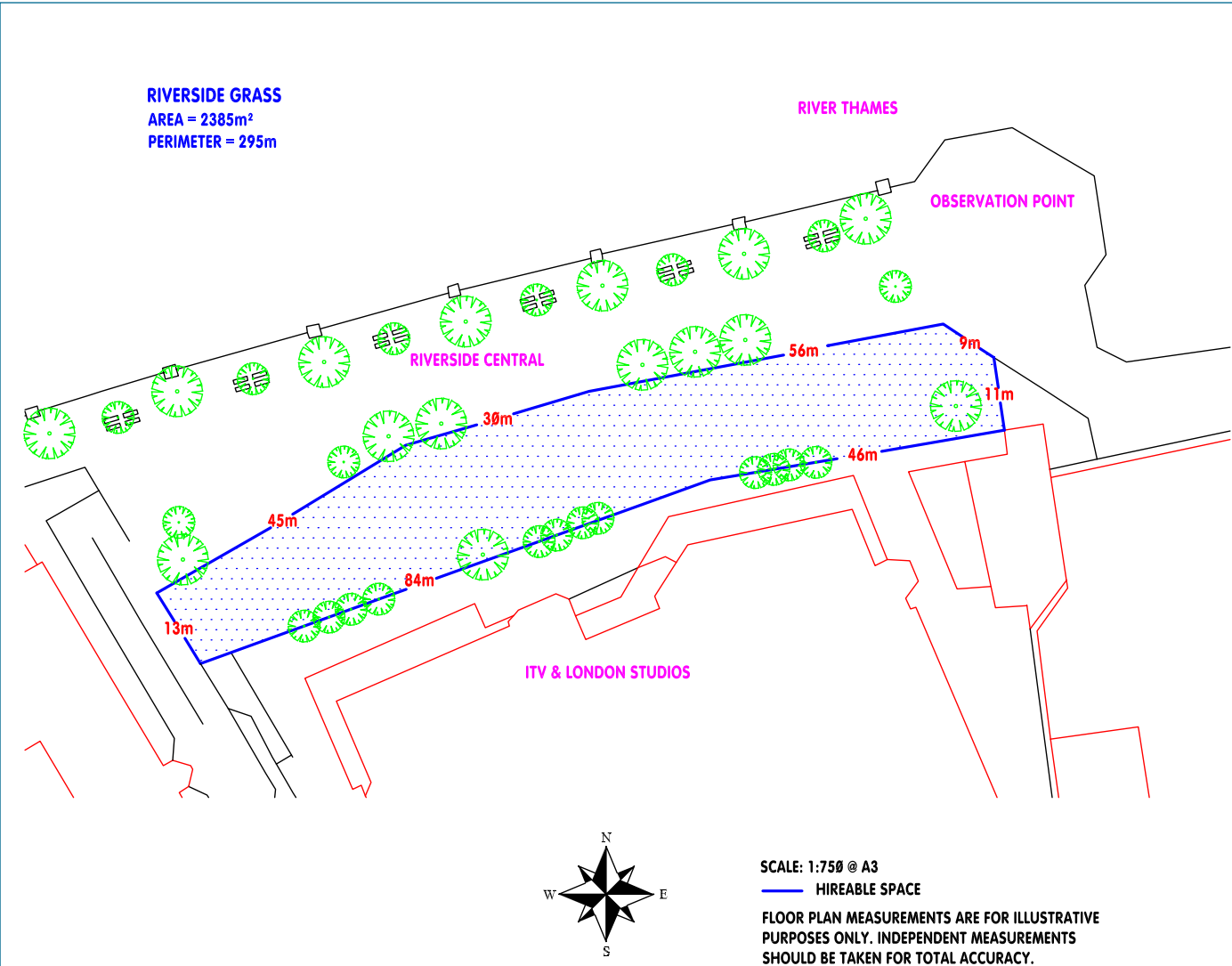

<b>SIZE</b>	2,385m <sup>2</sup>
<b>SURFACE</b>	Grass
<b>POWER</b>	2x16 amp single phase + (subject to availability) 1x63 amp 3 phase supply or 2x32 +2x16 amp single phase supply
<b>WATER</b>	Tap access to water
<b>ACCESS</b>	Vehicle access to site (size and weight restrictions apply)

**CAD PLAN AVAILABLE ON APPLICATION**

“ The Riverside Grass was a fantastic space to activate Malaysia Spring Market due to the quantities of people who are walking on the South Bank. When you're attempting to showcase a product these are precisely the types of time rich people you need.”

**Your Audience Ltd**



**BULMERS CIDER GARDEN**



# SMALLER EVENTS WANTING BIG FOOTFALL

EMAIL | [EVENTS@COINSTREET.ORG](mailto:EVENTS@COINSTREET.ORG)  
TELEPHONE | 020 7021 1650

13





# RIVERSIDE WEST

This prime pitch delivers 80m<sup>2</sup> of promotional space on the bustling Riverside Walkway. Adjacent to the National Theatre and IBM it's an ideal location for smaller events wanting big footfall. Daily hire fee concessions are also available for bookings of seven days or more and for exhibitions.

The bustle of this versatile river walk strip makes it a key part of cultural festival hires and supplies a perfect 'bolt on' location to Observation Point and Riverside Grass hires.

We offer flexibility in the location of Riverside Central. Your chosen space can be adjacent to the Thames, a central strip or alongside the Riverside Grass.

## RIVERSIDE CENTRAL

EMAIL | [EVENTS@COINSTREET.ORG](mailto:EVENTS@COINSTREET.ORG)  
TELEPHONE | 020 7021 1650

14

“Riverside West was a perfect location for ‘Step into Africa’. The fantastic footfall, right demographic and prestigious location made it a hugely successful campaign.”

**Top Dog Promotions**





# RIVERSIDE WEST AND RIVERSIDE CENTRAL TECHNICAL SPECIFICATIONS

EMAIL | [EVENTS@COINSTREET.ORG](mailto:EVENTS@COINSTREET.ORG)  
TELEPHONE | 020 7021 1650

15

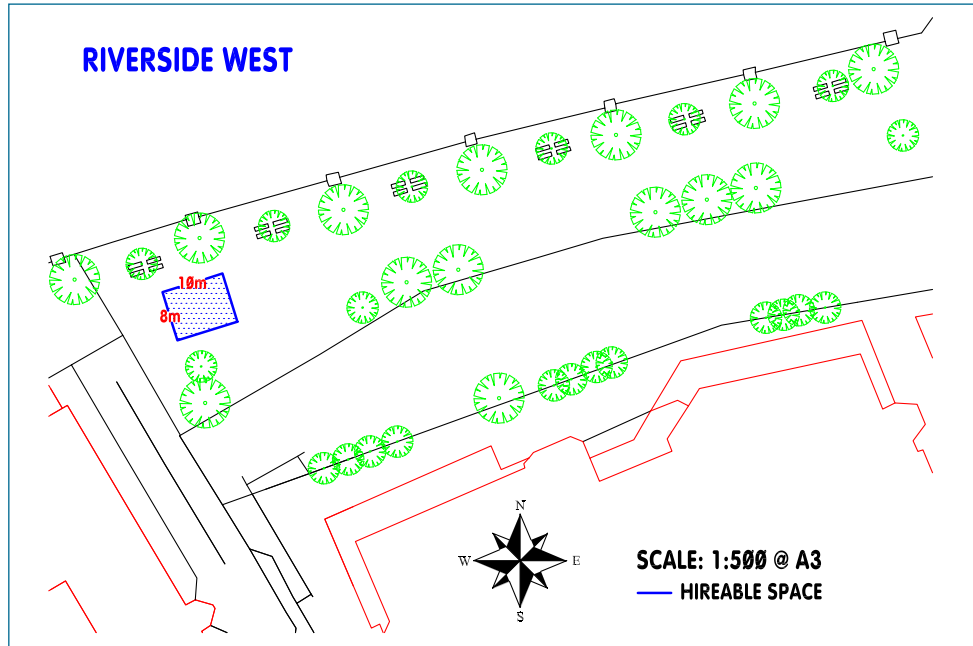

<b>SIZE</b>	80m <sup>2</sup> max. footprint available. Location movement possible on application.
<b>PERIMETER</b>	36m
<b>SURFACE</b>	Cobble and clear mac resin
<b>POWER</b>	2x16 amp single phase
<b>WATER</b>	Tap access near to site
<b>ACCESS</b>	Vehicle access to site (size and weight restrictions apply)

**CAD PLAN AVAILABLE ON APPLICATION**

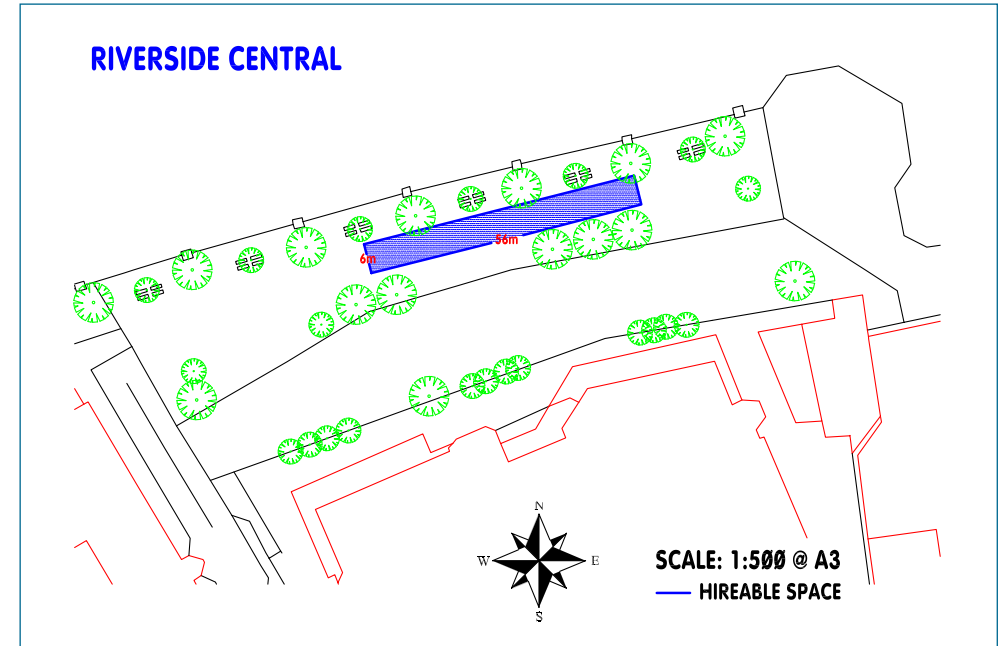

<b>SIZE</b>	336m <sup>2</sup> max. footprint available. Location movement possible on application.
<b>PERIMETER</b>	124m
<b>SURFACE</b>	Cobble and clear mac resin
<b>POWER</b>	6x16 amp single phase + (subject to availability) 1x63 amp 3 phase supply or 2x32 + 2x16 single phase supplies
<b>WATER</b>	Tap access near to site
<b>ACCESS</b>	Vehicle access to site (size and weight restrictions apply)

**CAD PLAN AVAILABLE ON APPLICATION**

Floor plan measurements are for illustrative purposes only. Independent measurements should be taken for total accuracy.



# RIVERSIDE OASIS

EMAIL | [EVENTS@COINSTREET.ORG](mailto:EVENTS@COINSTREET.ORG)  
TELEPHONE | 020 7021 1650

16





# BERNIE SPAIN GARDENS

Alongside Oxo Tower Wharf and beside the Thames, Bernie Spain Gardens offers 2,600m<sup>2</sup> of uninterrupted riverside park space.

The garden can be hired on its own or in conjunction with the neighbouring 145m<sup>2</sup> wooden jetty – the perfect VIP guest location to watch any river-based event.



EMAIL | [EVENTS@COINSTREET.ORG](mailto:EVENTS@COINSTREET.ORG)  
TELEPHONE | 020 7021 1650

17

“Working with the Supervisor enabled us to plan and deliver a complex activity far faster than a 3rd party contractor. It meant despite impossible time frames we were able to deliver an extraordinary job effortlessly despite the complexity.”

**CURB**



**TARGET PARK**



**THAMES FESTIVAL**



**OXO PEUGEOT DESIGN AWARDS**



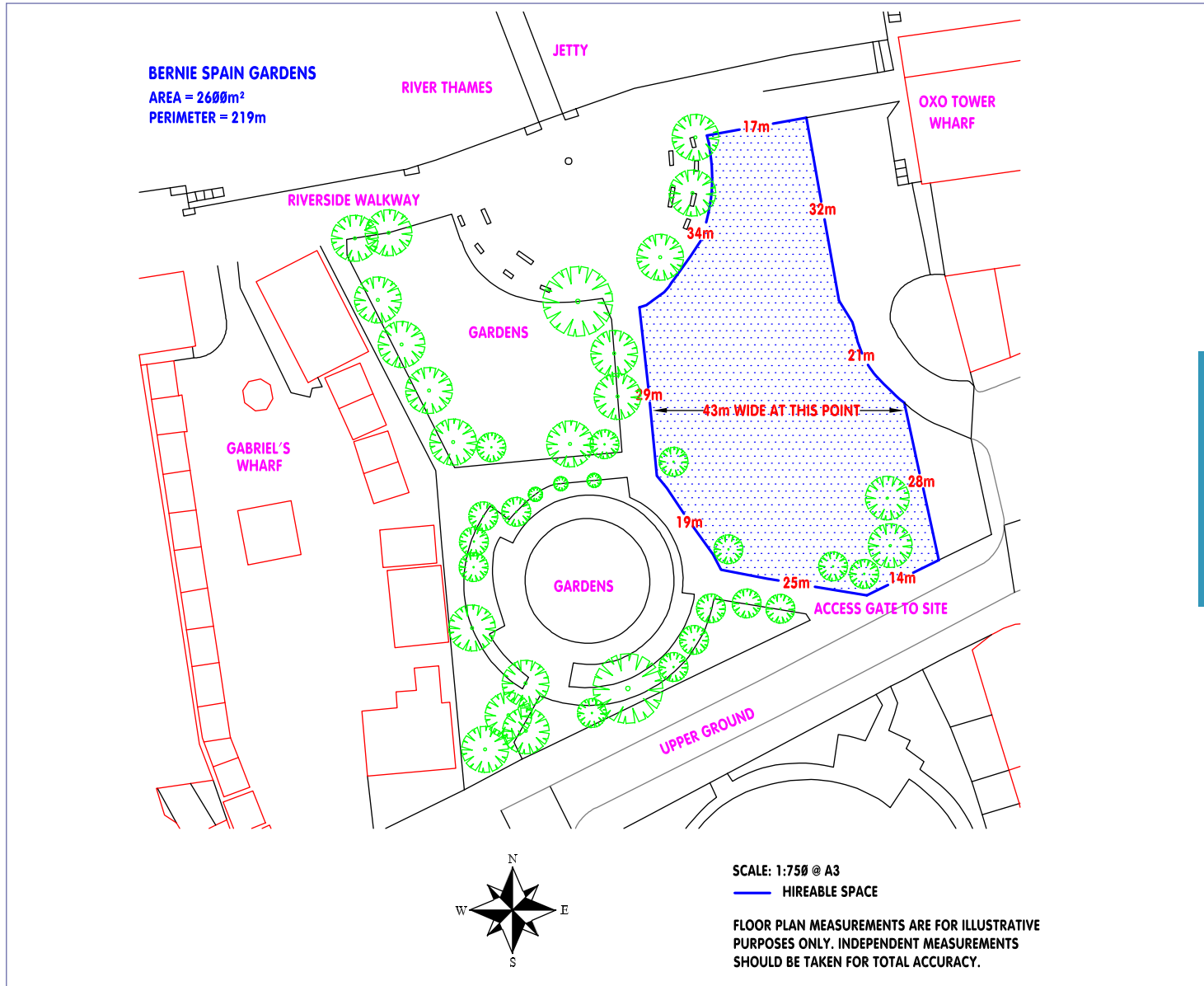

<b>SIZE</b>	2,600m <sup>2</sup>
<b>SURFACE</b>	Grass
<b>POWER</b>	1×63 amp 3 phase supply or 2×32 + 2×16 + 2×13 amp single phase supplies (subject to availability)
<b>WATER</b>	Tap access near to site
<b>ACCESS</b>	Vehicle access to site (size and weight restrictions apply)

### CAD PLANS AVAILABLE ON APPLICATION

“ Good Morning Britain love coming live from the South Bank on a summer's day. It has the most stunning and iconic views of London; its scenery is breathtaking and our presenters and guests enjoy the location. Coin Street couldn't be more helpful in accommodating our live programmes.”

ITV Breakfast Television

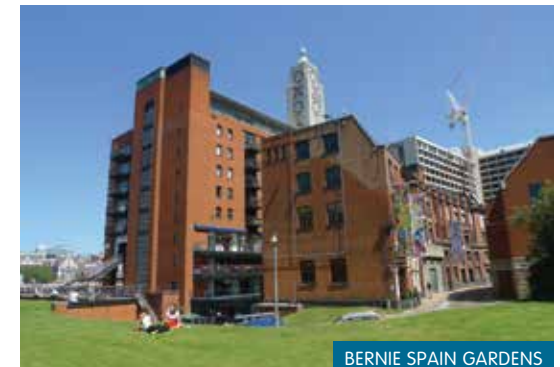



# QUEEN'S STONE

Her Majesty The Queen laid the Queen's Stone at an official ceremony in 1987 celebrating the opening of the Queen's Riverside Walkway. Surrounding this little jewel of South Bank history is a 648m<sup>2</sup> semi-circle of cobbled riverside walkway. Adjacent to the Thames alongside Oxo Tower Wharf, this tree covered haven offers a site that lies directly on the bustling walkway. It also offers the option to recess back into the park providing a tranquil stop-off point to interact with experiential activities.

EMAIL | [EVENTS@COINSTREET.ORG](mailto:EVENTS@COINSTREET.ORG)  
TELEPHONE | 020 7021 1650

19

“Coin Street always offer exceptional service and on point suggestions for amplification.”

**Looking Glass**



CORONA EXTRA BAR



THE BELFRY



CROWDS



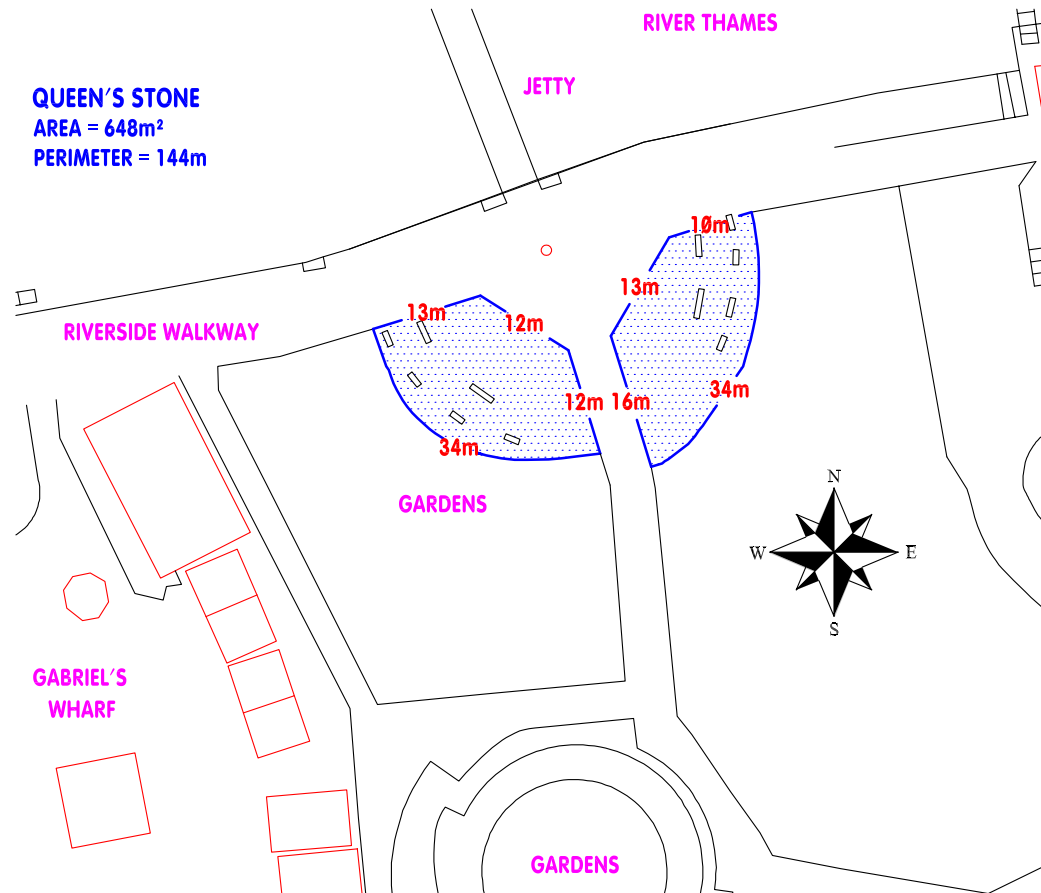

SCALE: 1:500 @ A3

— HIREABLE SPACE

FLOOR PLAN MEASUREMENTS ARE FOR ILLUSTRATIVE PURPOSES ONLY. INDEPENDENT MEASUREMENTS SHOULD BE TAKEN FOR TOTAL ACCURACY.

<b>SIZE</b>	648m <sup>2</sup>
<b>SURFACE</b>	Cobble
<b>POWER</b>	3x16 amp single phase + (subject to availability) 1x63 amp 3 phase supply or 2x32 + 2x16 + 2x13 amp single phase supplies
<b>WATER</b>	Tap access near to site
<b>ACCESS</b>	Vehicle access to site (size and weight restrictions apply)

### CAD PLANS AVAILABLE ON APPLICATION

“I have overseen many successful campaigns on the Observation Point and more recently the Queen's Stone, which is a fantastic site from Coin Street. With the right campaign I'm always happy to advise my clients to activate on South Bank, it's a truly great space. Campaign objectives are usually met and often exceeded.”

JC Decaux Live



QUEEN'S STONE





# JETTIES

Anchored in the Thames and providing unrestricted views spanning Somerset House to St Paul's, these two 30+ metre river jetties propel events right into the heart of the river. Both the Queen's Stone Jetty and the Oxo Jetty offer a truly unique opportunity to host bespoke river experiences to private guests and the public alike.

## RIVERSIDE SLICE

With over 743m<sup>2</sup> of riverside space, Riverside Slice provides a green space haven adjacent to the Thames. Perfect for bigger events with smaller budgets. Daily hire fee concessions are also available for bookings of five days or more and for exhibitions.

“A versatile space in such a central location is a rarity in London and the events team are a pleasure to work with. We look forward to utilising further event spaces in the future.”

**Awesome Events**



OXO JETTY



RIVERSIDE SLICE



QUEEN'S STONE JETTY



# QUEEN'S STONE JETTY, OXO JETTY AND RIVERSIDE SLICE TECHNICAL SPECIFICATIONS

EMAIL | [EVENTS@COINSTREET.ORG](mailto:EVENTS@COINSTREET.ORG)  
TELEPHONE | 020 7021 1650

22

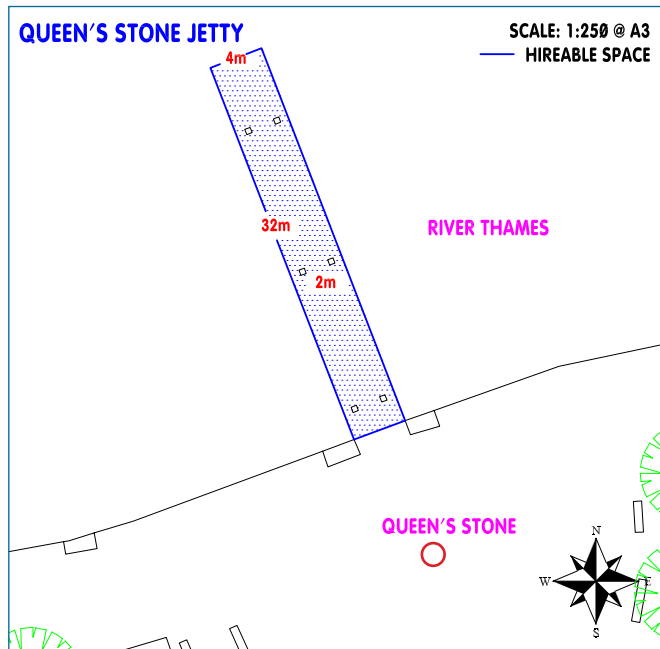

<b>SIZE</b>	145m <sup>2</sup>
<b>PERIMETER</b>	73m
<b>SURFACE</b>	Wooden decking
<b>POWER</b>	No power on site; cabling to Queens Stone/ Bernie Spain Gardens supplies possible (subject to availability)
<b>WATER</b>	Tap access near site
<b>ACCESS</b>	Vehicle access near to site (size and weight restrictions apply)

CAD PLANS AVAILABLE ON APPLICATION

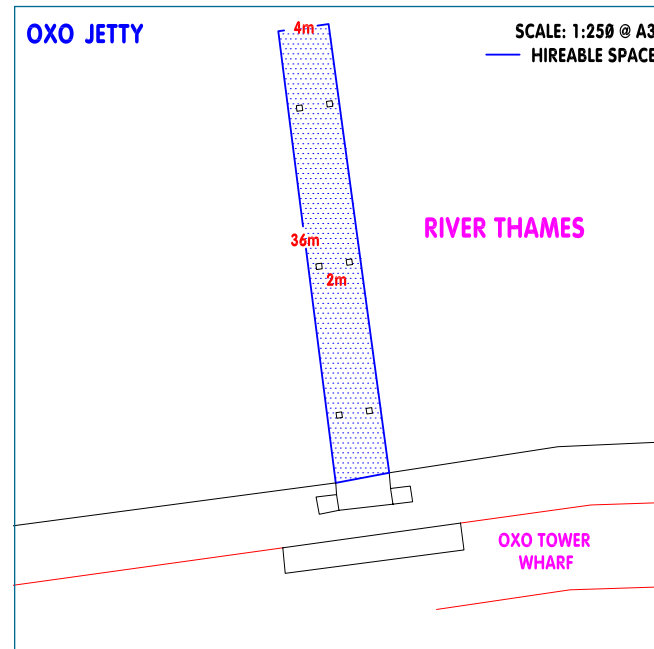

<b>SIZE</b>	159m <sup>2</sup>
<b>PERIMETER</b>	81m
<b>SURFACE</b>	Wooden decking
<b>POWER</b>	No power on site; cabling to Oxo Tower Wharf 13 amp supply possible
<b>WATER</b>	Tap access near site
<b>ACCESS</b>	Vehicle access near to site (size and weight restrictions apply)

CAD PLANS AVAILABLE ON APPLICATION

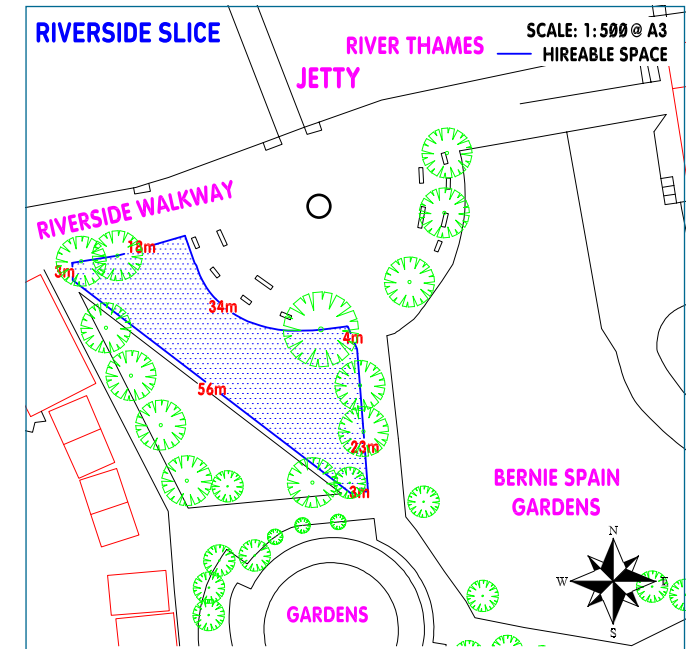

<b>SIZE</b>	743m <sup>2</sup>
<b>PERIMETER</b>	141m
<b>SURFACE</b>	Grass
<b>POWER</b>	3x16 amp single phase drop down supplies
<b>WATER</b>	Tap access near to site
<b>ACCESS</b>	Vehicle access near to site (size and weight restrictions apply)

CAD PLANS AVAILABLE ON APPLICATION

Floor plan measurements are for illustrative purposes only. Independent measurements should be taken for total accuracy.





AN UNRIVALLED  
BLANK CANVAS SITE  
IN CENTRAL  
LONDON



# DOON STREET CAR PARK

EMAIL | [EVENTS@COINSTREET.ORG](mailto:EVENTS@COINSTREET.ORG)  
TELEPHONE | 020 7021 1650

24

“Doon Street car park offers a large practical space which can be transformed into an incredible event experience whilst still offering great views of the South Bank. Coin Street and their Venue Supervisors were extremely professional and a pleasure to work from start to finish”

**Events in the Sky**



EVENTS IN THE SKY



EMIRATES GO EAST FESTIVAL



FORTESQUEUES SUMMER

A flexible ground level, non-height restricted, open air space nestled between BFI IMAX, South Bank's National Theatre and the ITV London Television Studios. Two minutes from the Riverside Walkway, this unique 5,097m<sup>2</sup> site is ideally located in the heart of the South Bank.

With seven metre gated access straight onto site from the road, Doon Street Car Park has played host to a variety of structures for launch events, parties and theatres including double-decker marquees and Spiegeltents. It has been temporary home to The Room on The River, smart's Urban Stage, La Soiree and Crazy Horse, amongst others.





# DOON STREET CAR PARK TECHNICAL SPECIFICATIONS

EMAIL | [EVENTS@COINSTREET.ORG](mailto:EVENTS@COINSTREET.ORG)  
TELEPHONE | 020 7021 1650

25

**DOON STREET  
CAR PARK**  
AREA = 5097m<sup>2</sup>  
PERIMETER = 323m

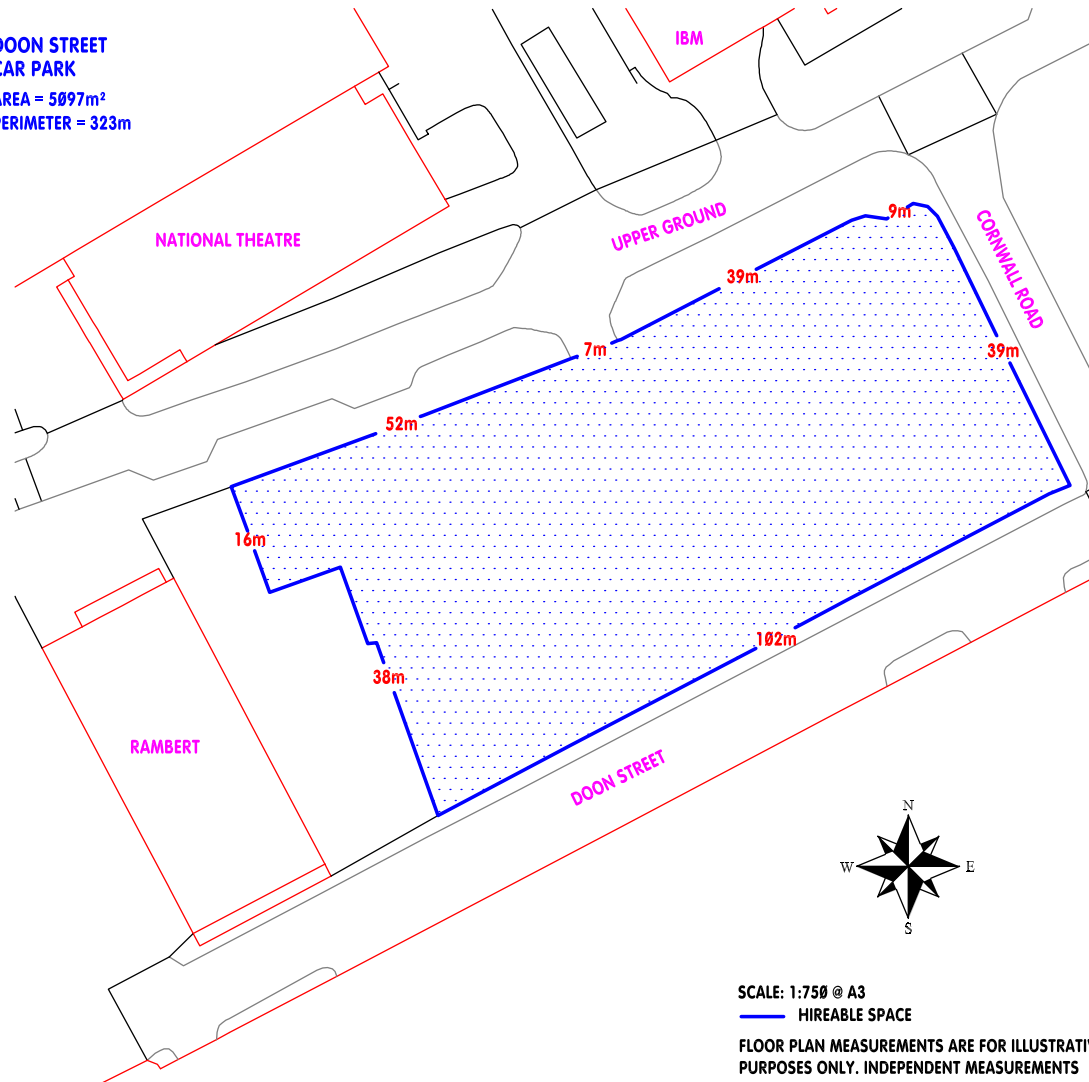

SCALE: 1:750 @ A3

— HIREABLE SPACE

FLOOR PLAN MEASUREMENTS ARE FOR ILLUSTRATIVE  
PURPOSES ONLY. INDEPENDENT MEASUREMENTS  
SHOULD BE TAKEN FOR TOTAL ACCURACY.

<b>SIZE</b>	5,097m <sup>2</sup>
<b>SURFACE</b>	Gravel
<b>POWER</b>	2x63 amp 3 phase supply + 1x32 + 1x16 + 1x13 amp single phase supplies
<b>WATER</b>	Tap access near to site
<b>ACCESS</b>	Vehicle access on to site

**CAD PLANS AVAILABLE ON APPLICATION**

“We’ve worked on the Doon Street Car Park site since 2010 running two large event structures as a theatre and for corporate events. The site is in a prime location on London’s South Bank and boasts excellent transport links via Waterloo, making it easily accessible for our guests to get to.”

**Awesome Events**





Positioned between The Green Room restaurant and BFI IMAX, Green Space is a brand new hire opportunity that offers a tranquil and secluded garden type venue perfect for private outdoor events, external product launches and company team building.

Situated two minutes walk from Waterloo station and visible from Waterloo Bridge, it's an enclosed, adaptable and over 850m<sup>2</sup> grassy canvas in a highly desirable central London location - making it ideal for pop-up leisure installations.



“ A well-maintained green space ideal for our charity firewalk—which is hard to come by in Central London. Coin Street was efficient and helpful every step of the way, and the convenient location helped us increase participant numbers. It was a highly successful event ”

**Action on Hearing Loss**



# GREEN SPACE

## TECHNICAL SPECIFICATIONS

EMAIL | [EVENTS@COINSTREET.ORG](mailto:EVENTS@COINSTREET.ORG)  
TELEPHONE | 020 7021 1650

27

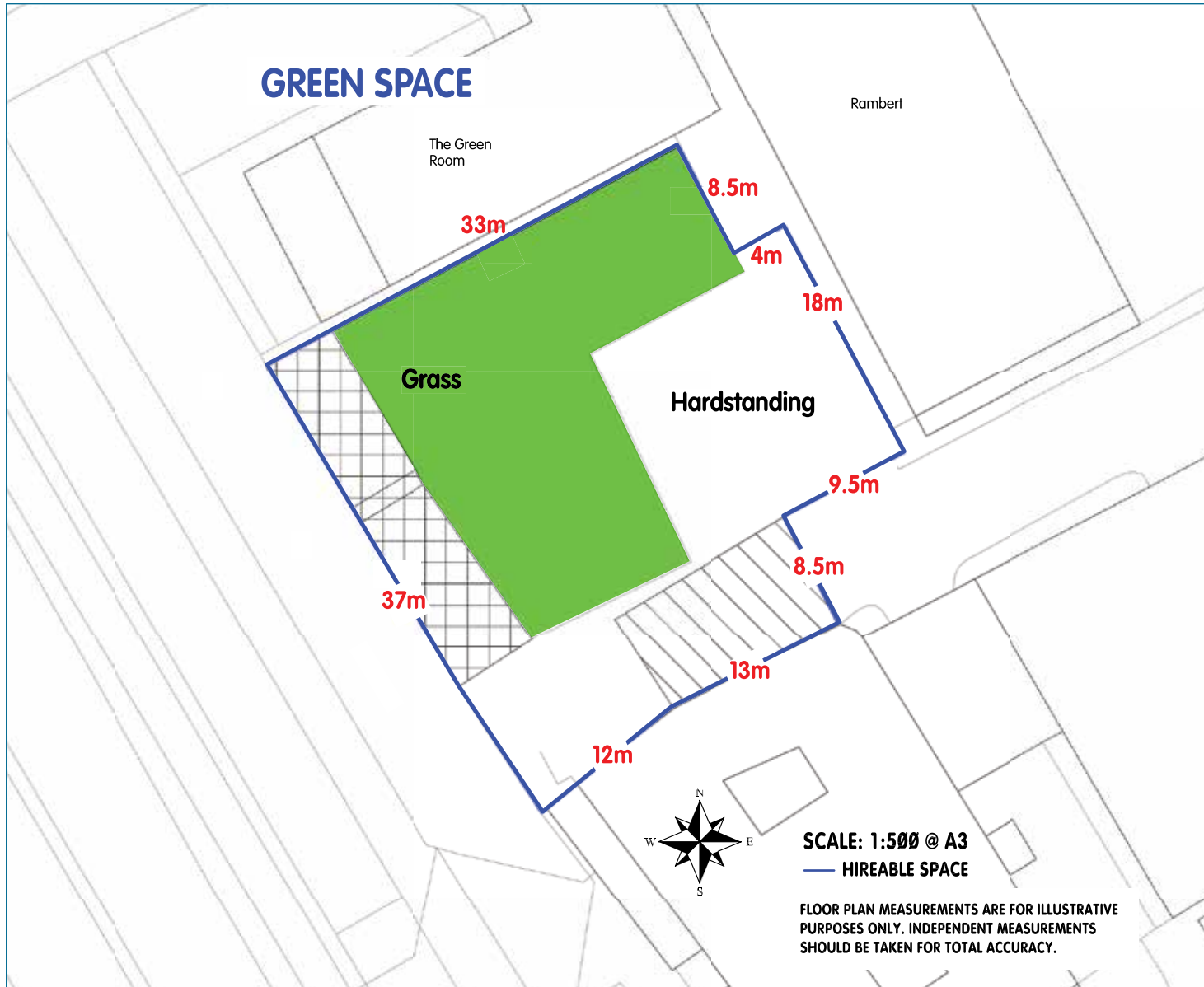

<b>SIZE</b>	850m <sup>2</sup> usable space
<b>SURFACE</b>	Grass & concrete hard standing
<b>POWER</b>	A 100amp supply that can be split to 1 x 63amp 3 phase or 2 x 32 3 phase and single phase via commando sockets
<b>WATER</b>	Tap access approx 100 meters to site and subject to availability.
<b>ACCESS</b>	Vehicle access to site (size and restrictions apply) Pedestrian access gate and steps side path off Upper Ground

### CAD PLANS AVAILABLE ON APPLICATION





# THE HEART OF CREATIVE LONDON





# COURTYARD & PLATFORM

EMAIL | [EVENTS@COINSTREET.ORG](mailto:EVENTS@COINSTREET.ORG)  
TELEPHONE | 020 7021 1650

29

At the centre of Oxo Tower Wharf, Courtyard and Platform offer flexible and open-air blank canvas spaces ready to be transformed.

Overlooked by the popular OXO Tower Bar, Brasserie and Restaurant, designer-maker studios and top design firms at Sea Containers House, Courtyard and Platform's prime location attracts both dwelling crowds and passing footfall. These perfect quirky pop-up spaces have hosted many external events and exhibitions; from robust sea containers housing Norwegian architecture shows to delicate domes housing an Olafur Eliasson creation and, most recently, the gloriously floral Remix Garden brought to fruition by Moore Harrison Land Design.



OXO PEUGEOT DESIGN AWARDS



THE AMAHORO GENERATION EXHIBITION



REMIX GARDEN 2: ANOUSHKA FEILER



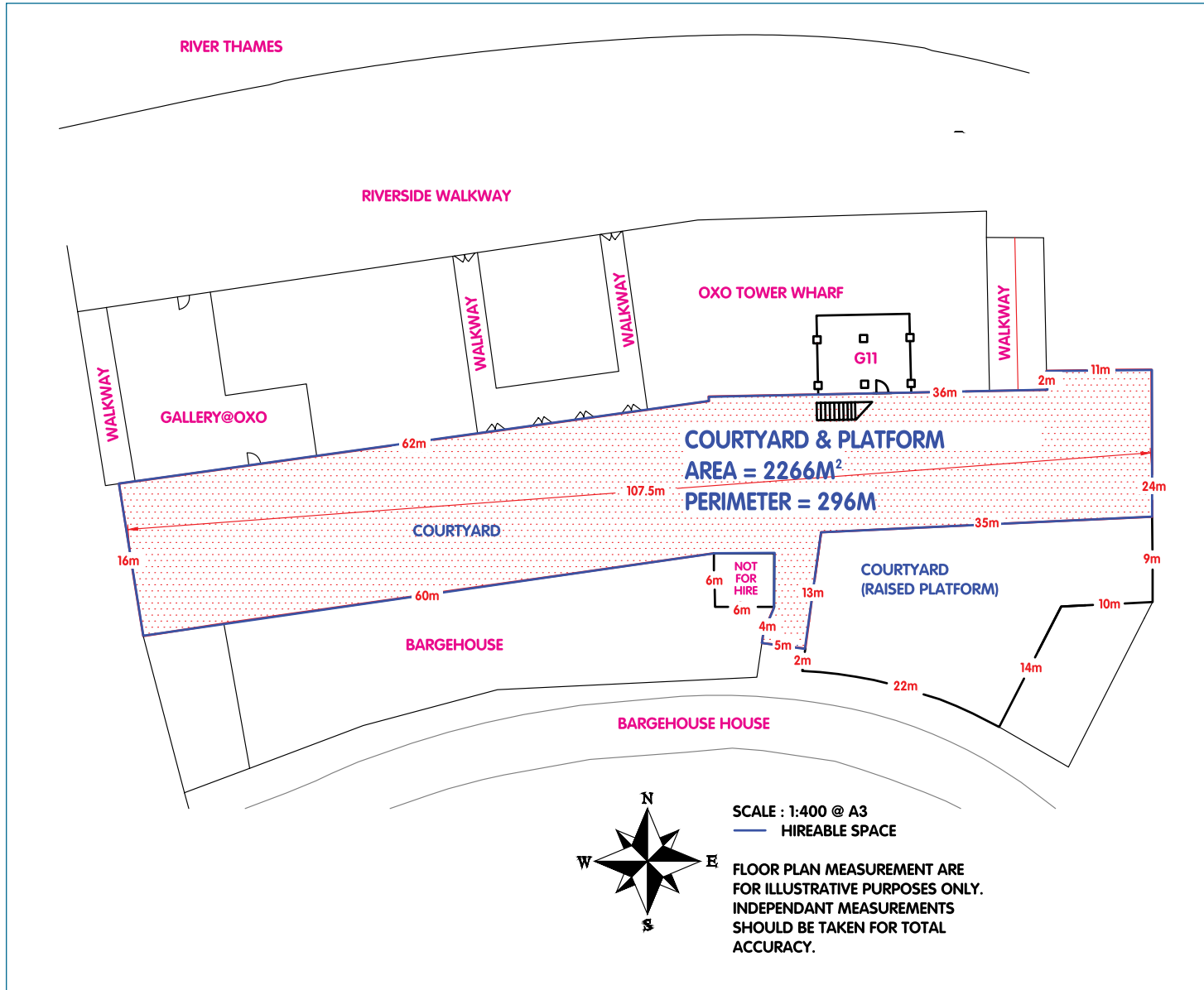

## SIZE

Courtyard 2266m<sup>2</sup>  
Platform 525m<sup>2</sup>

## SURFACE

Slate paving

## POWER

1 x 8 + 4 x 13 amp single phase supplies

## WATER

Tap access near to site

## ACCESS

Vehicle access adjacent to site on roadside (Council permits required)

## CAD PLANS AVAILABLE ON APPLICATION

“Coin Street couldn't be more helpful in accommodating our live programmes.”

ITV Breakfast Television Ltd



REMIX GARDEN 3: MATTHEW CHILDS





A unique opportunity to co-brand one of London's most iconic skyline buildings. Originally installed to flout advertising permissions in the 1930s', the red neon lights still proudly glow over the Thames.

Recent transformations saw it turned into the PS4 tower attracting 14.3 million views on Twitter within 24 hours of going live and for Valentine's day, OXO Tower blew night-time kisses to Londoners everywhere.

OXO  
TOWER



COUTTS LONDON JEWELLERY WEEK





# OXO TOWER TECHNICAL SPECIFICATIONS

EMAIL | [EVENTS@COINSTREET.ORG](mailto:EVENTS@COINSTREET.ORG)  
TELEPHONE | 020 7021 1650

32

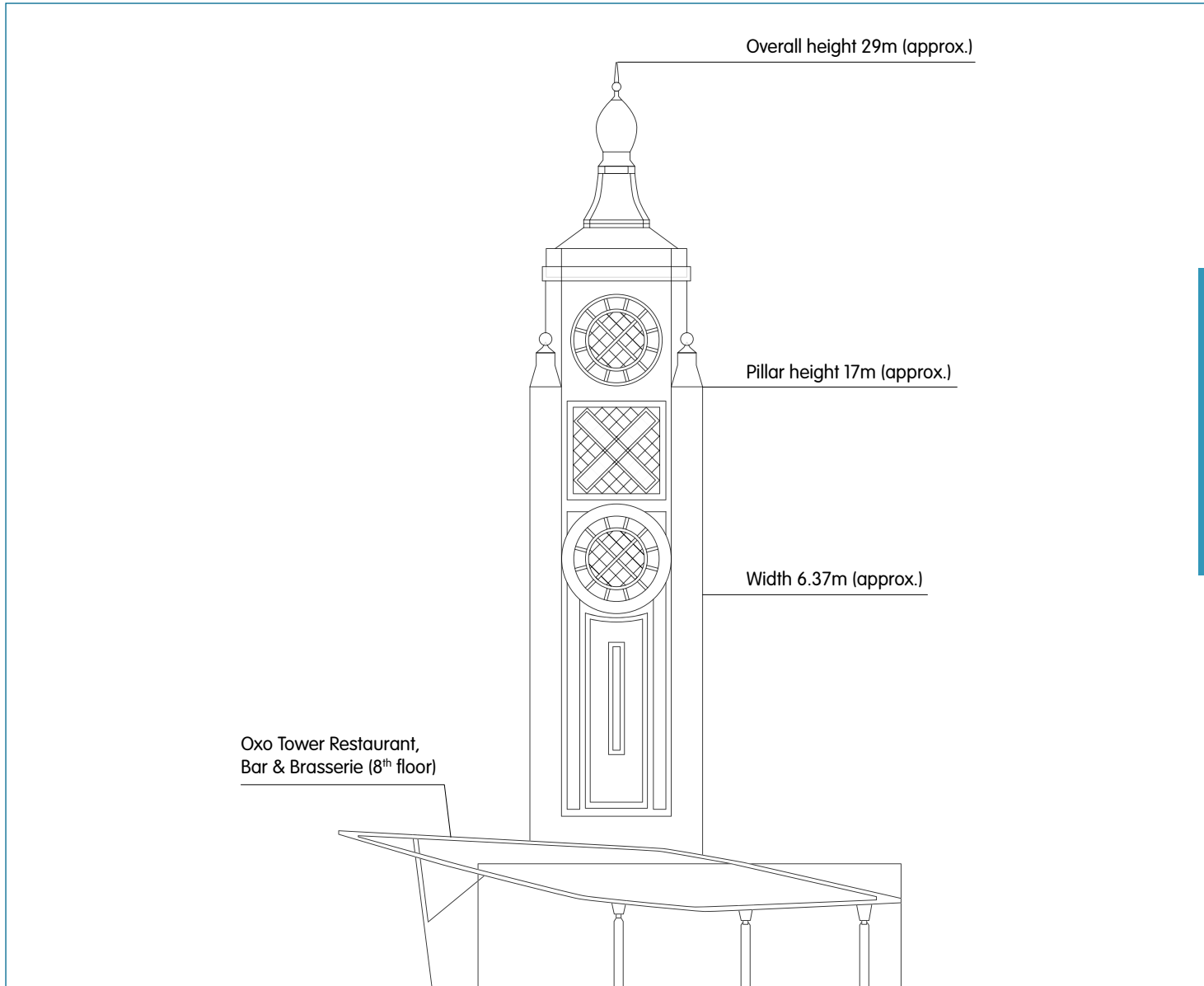

**SURFACE**  
**POWER**  
**WATER**  
**ACCESS**

Reinforced concrete and glass  
1x63 amp 3 phase  
None  
Via lifts/spiral staircase.  
Parking in Oxo Tower Wharf  
loading bay (subject to  
availability)

“Delivering the PS4 symbols on the OXO Tower and creating one of the most successful stunts in PR history was only made possible by the flexibility and pro-activity of the Coin Street team which is very rare in similar venues. The power of being in that location on the South Bank was a big factor in delivering over 50 million social media views and an iconic piece of marketing.”

**CURB**





# BARGEHOUSE

An exciting atmospheric space that forms the south side of Oxo Tower Wharf. A vast untouched four-storey building in a raw state, Bargehouse is a blank canvas with tremendous scope for indoor events. For optimum promotions the highly visible west facing flank wall is available to hire for huge banners in two size options.

EMAIL | [EVENTS@COINSTREET.ORG](mailto:EVENTS@COINSTREET.ORG)

TELEPHONE | 020 7021 1650

33



SCOTT HENSHALL FASHION SHOW



DOWN THE RABBIT HOLE PRODUCTION



JUDE EDGINTON PHOTOGRAPHY



Situated on the ground floor of Oxo Tower Wharf, the gallery@oxo is a 460m<sup>2</sup> bright South Bank riverside glazed space. Used daily to house exhibitions and events the gallery@oxo is a destination venue in its own right as well as benefitting from its prime location on the busy Riverside Walkway.



ROYAL OVERSEAS LEAGUE



HIDDEN ART



DAVID NOTON PHOTOGRAPHY



On the ground floor of Oxo Tower Wharf, facing the Courtyard & Platform, G11 provides 65m<sup>2</sup> of white walled space to transform. An airy hub primed for standalone pop-ups and product launches, G11 can also be used as a bolt on option for our larger venues or outdoor spaces.

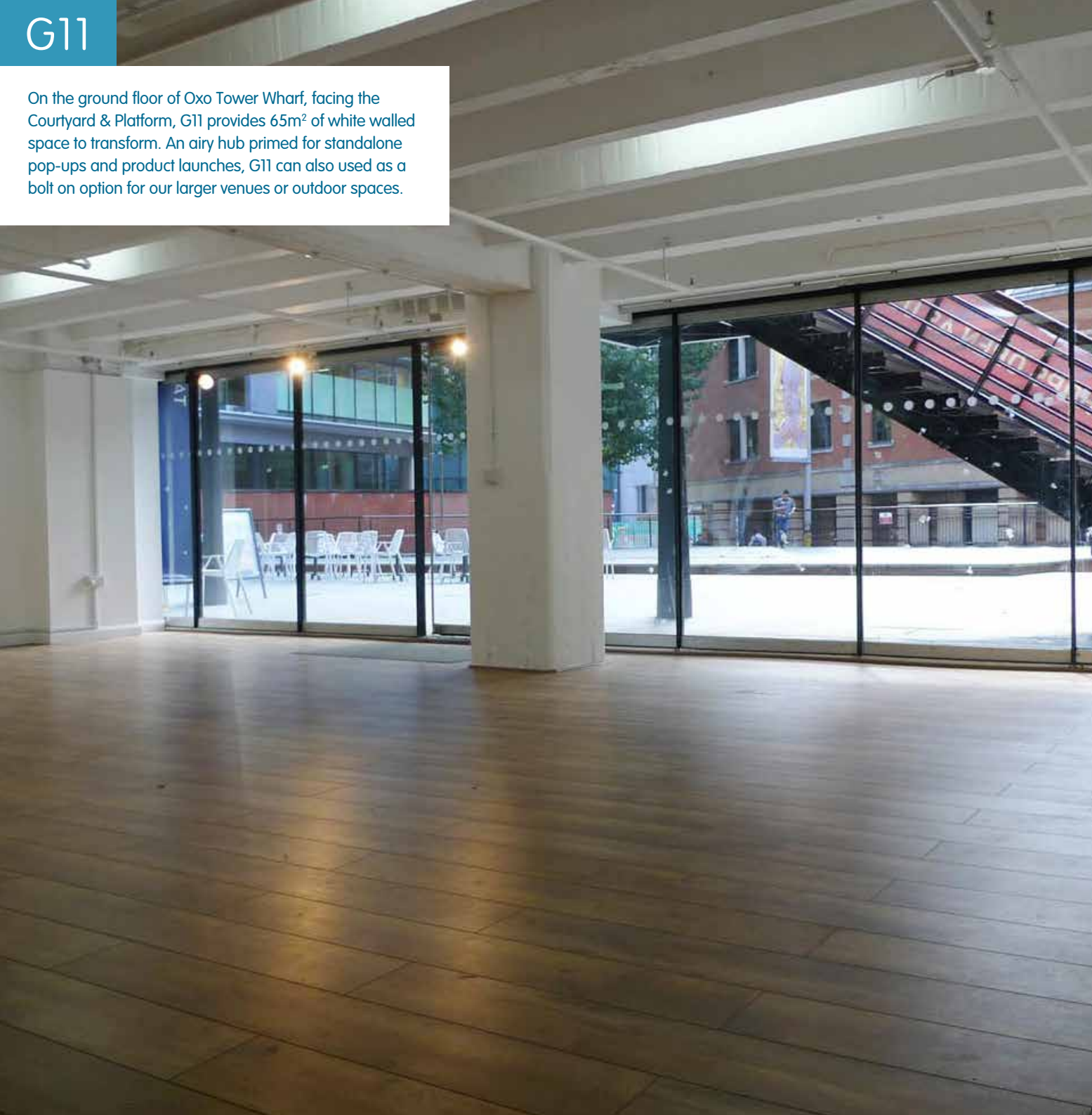

INSIDE OUT FESTIVAL



IMAGINATION LAB



BEATRICE PERRY LONDON



# FILMING INFORMATION

Alice Through the Looking Glass, Chef, Sherlock, Love Actually, Ant & Dec's Saturday Night Takeaway, ITV's This Morning, Loose Women, Good Morning Britain and Lorraine have all opted to film their central London scenes using our venues. Our 13 acre South Bank site offers an unrivalled mix of stunning views across the Thames to St Paul's Cathedral, green and leafy open spaces, the landmark OXO Tower and a large, centrally located open air car park suitable for anything from special builds to a unit base.

Download the filming request form to make an enquiry about filming and photo shoots across our sites at [coinstreet.org/venue-hire/filming](https://coinstreet.org/venue-hire/filming)

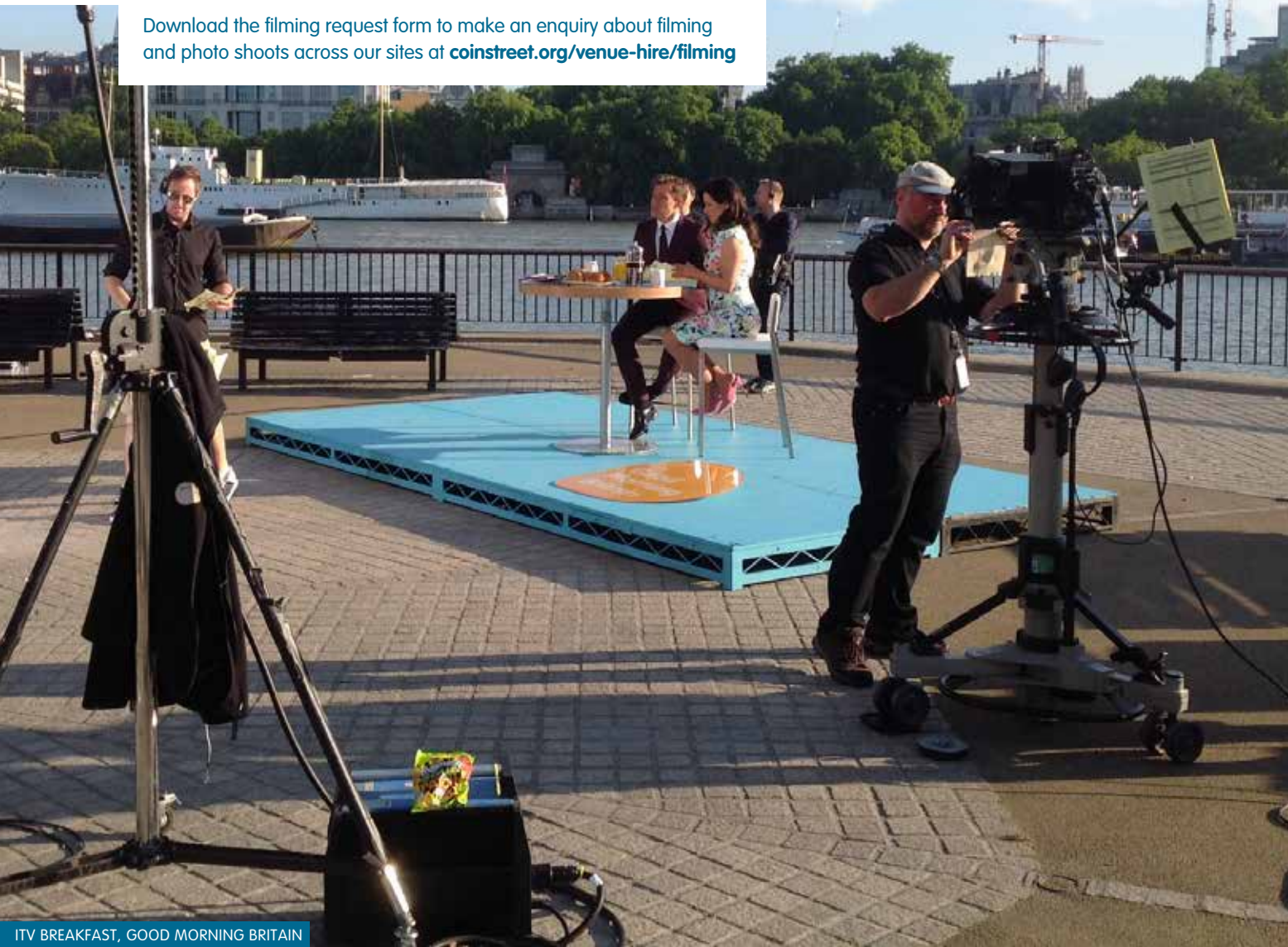

ITV BREAKFAST, GOOD MORNING BRITAIN

EMAIL | [EVENTS@COINSTREET.ORG](mailto:EVENTS@COINSTREET.ORG)  
TELEPHONE | 020 7021 1650

36



HUGH GRANT INTERVIEW



LAST CHANCE HARVEY



COLDPLAY VIDEO



# COIN STREET CONFERENCE CENTRE

Coin Street conference centre has a range of contemporary purpose-built meeting rooms accommodating between six and 250 people. As well as conferences, meetings and training events, the centre has also been used for extras' holding, costume and make-up, and auditions by film and TV production companies. In addition, our 4<sup>th</sup> floor Roof Terrace is ideal for filming locations looking to capture a South Bank view.

EMAIL | [EVENTS@COINSTREET.ORG](mailto:EVENTS@COINSTREET.ORG)  
TELEPHONE | 020 7021 1650

38



THIRD FLOOR SUITE



ROOF TERRACE



SOUTH BANK FOYER



# Rates, Additional Services, Fees and Marketing

## Daily Rates

1 April 2024 - 31 March 2025

<b>Bernie Spain Gardens</b>	£6,000 + VAT
<b>Doon Street Car Park</b>	£6,000 + VAT
<b>Green Space</b>	£3,300 + VAT
<b>Jetty – Oxo Tower Wharf</b>	£4,300 + VAT
<b>Jetty – Queen's Stone</b>	£4,300 + VAT
<b>Observation Point</b>	£7,500 + VAT
<b>Queen's Stone</b>	£6,000 + VAT
<b>Riverside Central</b>	£6,000 + VAT
<b>Riverside Grass</b>	£6,000 + VAT
<b>Riverside Slice</b>	£3,100 + VAT
<b>Spot by the River</b>	£2,500 + VAT
<b>Courtyard &amp; Platform</b>	On application (Applied Art subsidies possible)
<b>Oxo Tower</b>	On application and subject to approval
<b>gallery@oxo</b>	£3,000 + VAT £2,000 + VAT per build and de-rig days

## Venue Supervisor

All activities across the venues are required to have a Venue Supervisor. Possessing a wealth of site knowledge, the Supervisors not only provide on-site guidance on the day but also act as a dedicated liaison for logistical and technical queries during the planning process.

### Venue Supervisor - event / booking

Minimum call out of up to 5 consecutive hours. £175+VAT, £35+VAT per hour or part thereof thereafter.

### Venue Supervisor Technical Recce on site meeting

Minimum call out of up to 5 consecutive hours. £175+VAT.

### Fees applicable

- One day hire period - access time through to departure time
- Two or more day hire period - during all set up and de-rig activities and if vehicle access is required outside of these times. Venue Supervisors may also be required during events deemed sensitive, guidance on application.

## Power and Water

Three-phase and single-phase power is available subject to venue; meters are read start and end of hire and charged at 18p+VAT per unit.

### Riverside Parks and Gardens

35p+VAT per unit

### Green Space

35p+VAT per unit

### Doon Street Car Park

46p+VAT per unit

Water is available from a number of tap stands around the site and charged at a flat fee of £15+VAT per day.

## Music, Entertainment and Alcohol

We have a premises licence that permits sampling/selling food 8am-9pm, alcohol 12 noon-9pm, and entertainment, film, music etc 10am-8/9pm, depending on the venue. Events with alcohol (sold or served/private or public audience) must provide an appropriate number of Personal Licence Holders on site at all times as well as identifying a Designated Premises Supervisor.

## Promotional Support

Subject to availability, deadlines and print dates, we are able to offer:

- Inclusion in e-newsletters
- Inclusion on our website with a link to your own site
- Promotion on social media, eg Facebook, Twitter, etc
- Possible inclusion in free events poster listings on South Bank information structures – (approximately 39). Please note we do not have final editorial control over these
- The subsidised hire costs of 3-6 back lit poster sites along the Coin Street site for exclusive event promotion.

## Security, Waste Management and Event Support

If your event requires AV, catering, event management or project management we also have a list of suppliers we can recommend who know and understand our sites.

## Damage Deposits

Dependent on venue, event and event duration, damage deposits are charged between £350 and £1,000 excluding Oxo Tower.

\* Prices correct at time of publishing, Jan 2025

events@coinstreet.org | 020 7021 1650



# WHY CHOOSE COIN STREET?

**By choosing Coin Street's sites for your event you are investing in the future of the South Bank and the local neighbourhood.**

- Coin Street Community Builders (CSCB) is a social enterprise and our aim is to make our neighbourhood a great place to live, work in, and visit.
- CSCB has transformed a largely derelict 13 acre site into a thriving mixed-use neighbourhood
- CSCB has built new co-operative homes; completed the South Bank Riverside Walkway; created Bernie Spain Gardens; refurbished Oxo Tower Wharf for mixed uses; hosts conferences; organises festivals and events; and provides childcare, family support, learning, sports and a wide range of other community programmes
- Income is generated from a variety of sources including the hire of retail and catering spaces, event spaces, meeting room spaces and conference venue spaces
- CSCB is a company limited by guarantee established by local residents in 1984 following a campaign against large scale office proposals
- Profits are not distributed but are ploughed back into Coin Street's public service objectives



A COMMUNITY  
WORKING TOGETHER





# CONTACT US

For more information, to book or view any of the spaces we have available contact the events team on **020 7021 1650** or email **[events@coinstreet.org](mailto:events@coinstreet.org)**

Coin Street neighbourhood centre,  
108 Stamford Street, South Bank, London SE1 9NH  
**[www.coinstreet.org/venue-hire](http://www.coinstreet.org/venue-hire)**